

Harnett - Johnston

February 2019



Blue Ridge Mountains, North Carolina

NC811 Board Meeting – Jan. 2019



Lyman Horne Receives
the Ray Killough Award



NC811 Open House – Jan. 2019



A photograph of a sunset over a mountain range. The sun is low on the horizon, casting a warm glow across the sky. The mountains are silhouetted against the bright sky. The text '2018' is overlaid in large, white, sans-serif font, centered horizontally. The sun is positioned behind the '0' in '2018'.

2018

what a great year!

A man in a suit and red tie is pointing his right index finger at a blue hexagon. The background is a dark blue grid of hexagons with various business icons. The text 'business analytics' is written in white inside the blue hexagon.

**business
analytics**

The logo for North Carolina 811. 'North' is in green, 'Carolina' is in green, and '811' is in yellow. Below 'Carolina' is the website 'www.nc811.org' in yellow. To the right is a stylized shovel icon with a green blade and a brown handle.

North Carolina 811
www.nc811.org



Locate Requests & Transmissions

Jan. 2019 vs 2018

Tickets

2019: 187,878
2018: 152,459
Difference: 23.2%

Transmissions

2019: 1,037,905
2018: 864,096
Difference: 23.3%

REMOTE TICKET ENTRY

Total Tkt Summary	187,878
In-House Tkt Summary	63,540
RTE Ticket Summary; incl. UL	124,338
RTE Ticket Summary; excl. UL	100,317
RTE % Volume; excl. UL	53.39%
RTE % Volume	66.18%

RTE Volume 2019 vs 2018

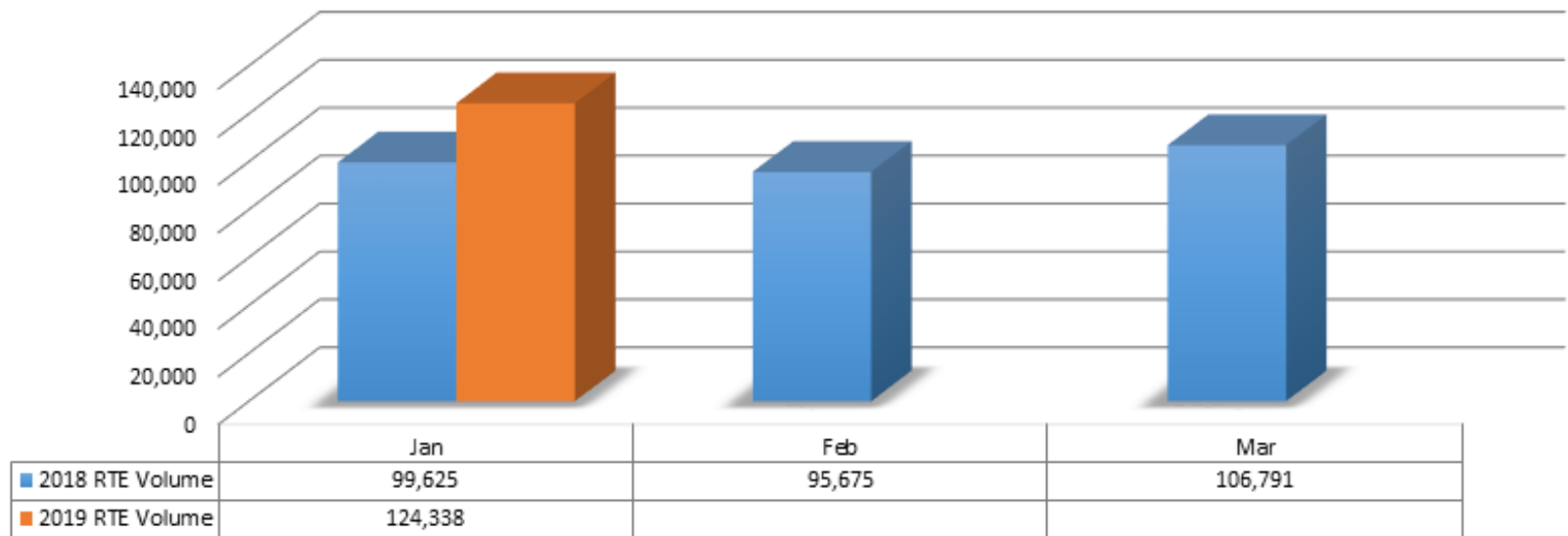



County Ticket Volume

YTD stats compared with previous year

Harnett	3 HR	CNCL	NEW	RXMT	UPDT	Total Tickets
2018	17	16	1,089	28	363	1,513
2019	53	23	1,063	19	726	1,884
+/- Var	211.8%	43.8%	-2.4%	-32.1%	100.0%	24.5%
Locates per day						99

County Ticket Distribution

HARNETT	1,884	DUNCAN	13
ANDERSON CREEK	88	DUNN	249
ANGIER	329	ERWIN	221
ARLINGTON	1	HARNETT	3
AVERASBORO	4	JOHNSONVILLE	42
BARBECUE	18	KIPLING	29
BARCLAYSVILLE	19	LILLINGTON	431
BOONE TRAIL	1	OLIVIA	54
BROADWAY	31	OVERHILLS	4
BUIES CREEK	35	PINEVIEW	2
BUNNLEVEL	64	SPOUT SPRINGS	56
CAPE FEAR	1		
CHALYBEATE SPRINGS	9		
COATS	176		
COCKSBURY	4		



County Ticket Volume

YTD stats compared with previous year

Johnston	3 HR	CNCL	NEW	RXMT	UPDT	Total Tickets
2018	46	30	2,421	76	673	3,246
2019	143	24	2,842	68	936	4,013
+/- Var	210.9%	-20.0%	17.4%	-10.5%	39.1%	23.6%
Locates per day						211

County Ticket Distribution

JOHNSTON	4,013	JOHNSON CROSSROADS	3
ARCHER LODGE	63	KENLY	122
BENSON	365	MCGEE CROSSROADS	117
BENTONVILLE	1	MEADOW	23
BROGDEN	4	MICRO	26
CLAYTON	2,253	MOORES CROSSROADS	2
CORINTH HOLDERS	1	PINE LEVEL	46
DRUG STORE	13	PRINCETON	47
EARPSBORO	1	SELMA	203
EDMONDSON	25	SMITHFIELD	266
EMIT	6	STANCILS CHAPEL	2
FIVE POINTS	8	STRICKLAND CROSSROAD	1
FLOWERS	2	WESTVIEW	1
FLOWERS STORE	2	WILLOW SPRINGS	57
FOUR OAKS	140	WILSONS MILLS	138
HARES CROSSROADS	1	ZEBULON	72
HOCUTTS CROSSROADS	2		

Facility Damaged	Events	% of Grand Total
Telecommunications	244	36.64%
CATV	146	21.92%
Electric	86	12.91%
Water	66	9.91%
Natural Gas	62	9.31%
Unknown/Other	54	8.11%
Sewer	8	1.20%
Grand Total	666	100%

FACILITY DAMAGED

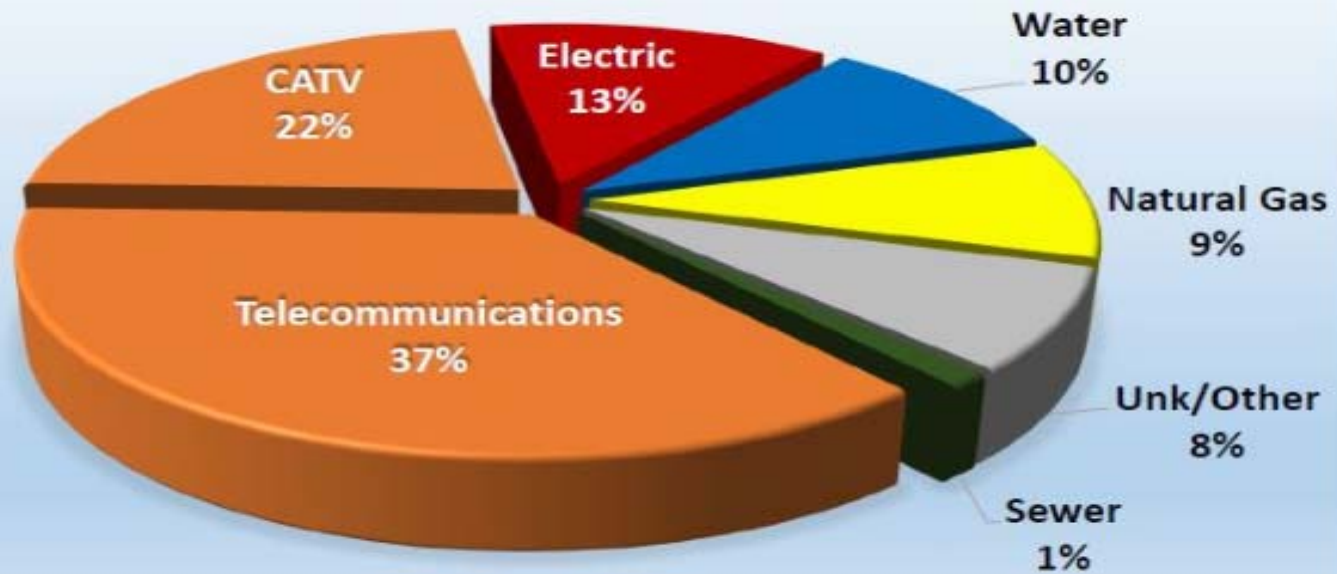

Damage Contact Info

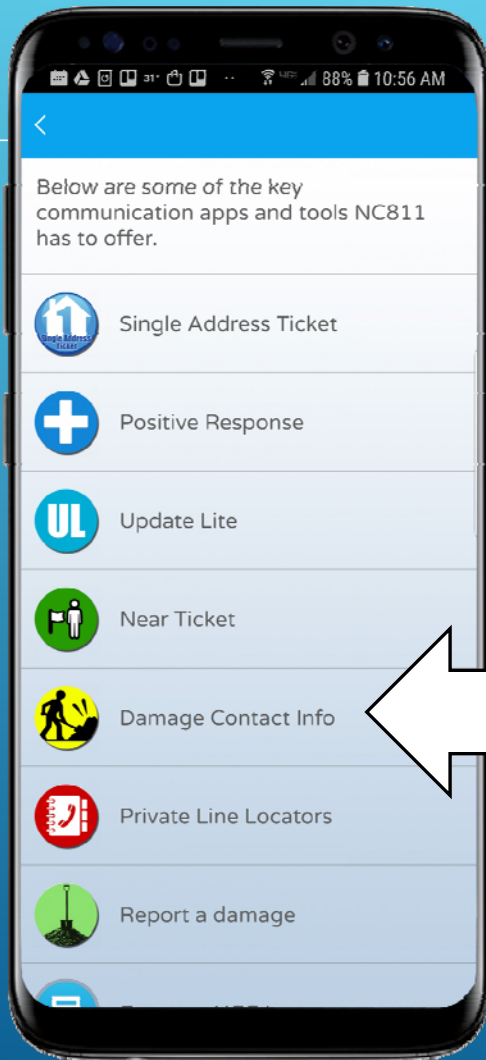

When a utility is damaged, know who to contact in your area with the **Damage Contact** section of the app.

County Member Damage Notification Information

NORTH CAROLINA

County

Members Notified for County ALAMANCE

Code	Name	Damage Contact	Phone
ATT01	ATT/T (TRANSMISSION)	ANTONIO J. PEIRANO	(803)261-4551
ATT312*	ATT/D (DISTRIBUTION)	ATT REPRESENTATIVE	(877)737-2478
ATT322*	ATT/D (DISTRIBUTION)	ATT REPRESENTATIVE	(877)737-2478
CAR01	CARDINAL PIPELINE COMPANY	GAS CONTROL	(800)440-8475
CAR02	CARDINAL PIPELINE COMPANY	GAS CONTROL	(800)440-8475
COB01	CITY OF BURLINGTON	ANDY MCCOY	(336)516-6525
COB02	CITY OF BURLINGTON	1 - DEAN COBLE	(336)516-6654
COB02	CITY OF BURLINGTON	2 - WALTER HARTMAN	(336)516-6655
COP02	COLONIAL PIPELINE COMPANY	CONTROL CTR SENIOR CONTROLLER	(800)926-2728
COP05	COLONIAL PIPELINE COMPANY	CONTROL CTR SENIOR CONTROLLER	(800)926-2728
CPL10*	DUKE ENERGY	DUKE ENERGY REPRESENTATIVE	(800)452-2777
CPL30*	DUKE ENERGY	DUKE ENERGY REPRESENTATIVE	(800)452-2777
CTT02*	CTLCL-CENTURYLINK	GENERAL NUMBER	(800)788-3600
CTT11*	CTLCL-CENTURYLINK	GENERAL NUMBER	(800)788-3600
CTT12*	CTLCL-CENTURYLINK	GENERAL NUMBER	(800)788-3600
CUB01	CONTERRA ULTRA BROADBAND	NETWORK OPERATIONS CENTER	(888)581-0811
CVI04*	TIME WARNER CABLE-CHARTER	CAROLINAS REGIONAL OPERATIONS	(855)272-2862
DET01*	TIME WARNER CABLE-CHARTER	CAROLINAS REGIONAL OPERATIONS	(855)272-2862
DOT07	NC DEPARTMENT OF TRANSPORTATION	MARK ALDRIDGE	(336)487-0175
DOT07A	NC DEPARTMENT OF TRANSPORTATION	OPERATIONS CENTER (EVENING)	(919)825-2653
DOT07A	NC DEPARTMENT OF TRANSPORTATION	TRIAD TMC (DAYTIME)	(336)315-7080
DPC11*	DUKE ENERGY	DUKE ENERGY REPRESENTATIVE	(800)769-3766
ELN01	TOWN OF ELON	1 - DAVID MURPHY	(336)214-0674
ELN01	TOWN OF ELON	2 - TJ TINGLE	(336)684-4296

**Your info should match
your white lined area**

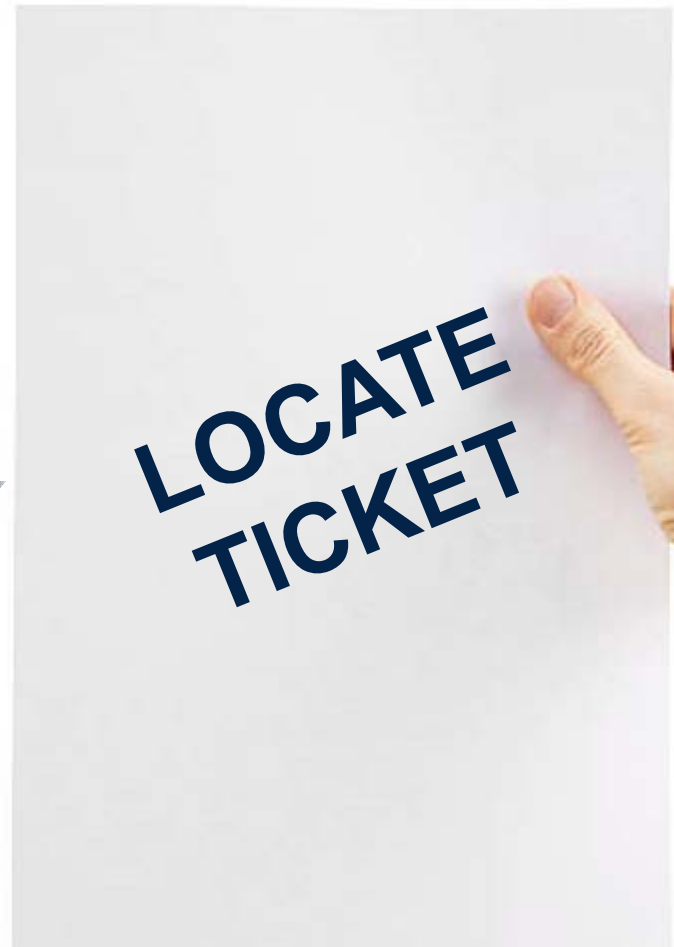



87-122 (c) (2) Confirm through positive response prior to excavation that all operators have responded & that all facilities that may be affected by the proposed excavation have been marked.

Member Response Codes

- 10 No conflict, utility is outside of stated work area
- 20 Marked
- 30 Not complete
- 32 Locate Not Complete, additional communication with the excavator required. Unable to contact the excavator.
- 40 Could not gain access to property, locator will contact excavator
- 50 Critical facility not marked, The utility owner or their designated representative have contacted the excavator and have agreed to a period that an owner representative must be present during excavation to identify the unmarked facility and/or monitor the excavation
- 55 Critical facility marked. The utility owner or their designated representative have contacted the excavator and have agreed that an owner representative must be present during excavation
- 60 Locator and excavator agreed and documented marking schedule
- 70 Excavator completed work prior to due date
- 80 Member's Master Contractor is responsible for locating facilities
- 90 SURVEY DESIGN REQUEST - Facility Has been Marked in the Field
- 92 SURVEY DESIGN REQUEST -No Facilities in the Area
- 94 SURVEY DESIGN REQUEST - Facility Records Provided
- 98 SURVEY DESIGN REQUEST - Access to Facility Records Provided
- 100 Location request denied due to Homeland Security Concern. Member utility operator needs to confirm legitimacy of the proposed excavation and may need additional information.
- 110 Subaqueous Facilities Present. Member utility owner will locate facilities within 10 full working days.
- 888 Extraordinary Circumstances Exist. Member utility owner unable to complete location request until (Date / Time).
- 999 Member has not responded by the required time

Destroyed Marks & 3 Hour Tickets

DESTROYED MARKS

If locate marks have been destroyed, the excavator must contact NC811 to issue a Destroyed Marks ticket requesting a remark of the area from the original ticket. A 3 Hour Ticket should not be used in case of destroyed marks.

3 HOUR TICKET

If an operator fails to respond to the positive response system, the excavator may proceed if there are no visible indications of a facility at the proposed excavation or demolition area, such as a pole, marker, pedestal, meter, or valve. However, if the excavator is aware of or observes indications of an unmarked facility at the proposed excavation or demolition area, the excavator shall not begin excavation or demolition until an additional call is made to the Notification Center detailing the facility and an arrangement is made for the facility to be marked by the operator within three hours from the time the additional call is received by the Notification Center.

Bad Weather Driving Tips

- Inspect their vehicles before departing. Check tires, lights, turn signals, wipers, windows, defroster, mirrors and loads. Report defects to the mechanic and have them repaired before you go on the road.
- Keep windows and lights clean and clear of dirt, snow, and ice.
- Use wipers, defrosters, and headlights to improve your visibility day or night. Headlights also help other drivers see you.
- Avoid distractions, such as cell phones or radios.
- Watch out for puddles and icy patches that could cause hydroplaning or skids.
- Do not attempt to drive through deep puddles. You could get stuck or wet the brakes.
- Avoid quick or sudden stops or turns.
- Increase your stopping distance.
- Wear your seat belt at all times and require passengers to do the same. There is no time for mistakes during bad weather. Bad weather affects all drivers. You must stay alert. Watch out for the other drivers, too. Drive defensively!

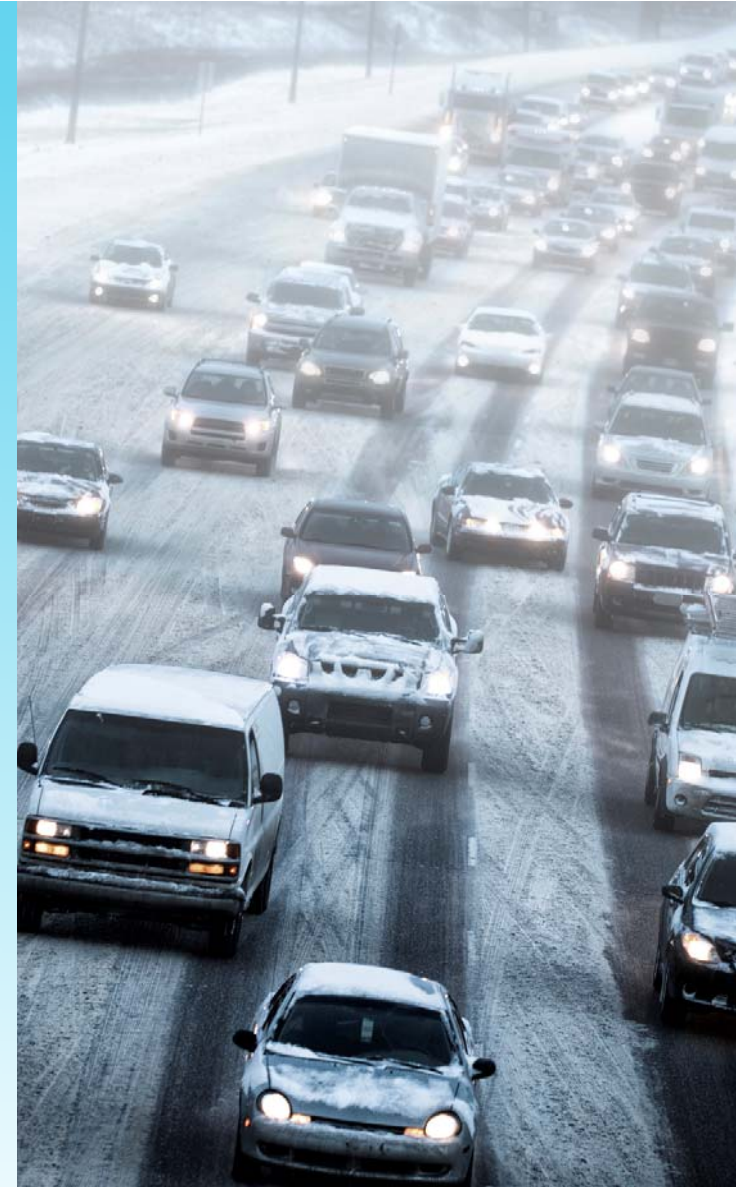



MEETINGS AND EVENTS



Meetings



- ▶ **NC811 Board Meeting 1Q19**
April 26th, 2019
8:30 am; DoubleTree by
Asheville Hilton – Biltmore, NC
- ▶ **NC Underground Damage
Prevention Review Board**
April 16, 2019 from 10 am to 4 pm
2550 Operation Way, Raleigh, NC
- **Locate Resolution Partnership
Committee**
The 3rd Wednesday,
Feb, April, June, August, Oct, Dec
11:00 am - 1:00 pm
5009 High Point Rd., Greensboro, NC
- **State UCC**
March 12, 2019 from 10 am to noon
Dominion Energy, 4211 Global St,
Raleigh, NC

Joint NC/SC Utilities



**Sheraton Myrtle Beach Convention Center
May 1st - May 3rd, 2019**

For more info and to register go to: www.scucc.org

National Safe Digging Month T-Shirts are here!



For more information, visit www.nc811.org

All t-shirt orders must be placed by Feb. 28, 2019



Thank you for your time and attention.
You can get a PDF copy of this presentation
on www.ncucc.org



Use the UCC Issues form to voice your concerns
to both local and state level UCC meetings in North Carolina.
Available on both the NCUCC website and the NC811 app.

HARNETT/ JOHNSTON COUNTY UTILITY COORDINATION COMMITTEE
SIGN IN SHEET

DATE 2/19/19

NAME	COMPANY NAME	PHONE #	E-MAIL ADDRESS
Andrew Smith	South River EMC	910-303-7579	asmith@sremc.com
Richard Starcil	Lee Elec	910-639-5248	rstarcil@lee-electrical.com
Michael McLean	Lee Elec	910 639 5840	mmclean@lee-electrical.com
Jamie Williams	Colonial Pipeline	919-414-5525	Jwilliams@colpipe.com
Tom Moyer	Graycliff	919-632-3948	tmoyer@graycliffert.com
A J Governali	SPECTRUM	919-218-4038	arthur.governali@charter.com
Tim CALLIHAN	TOWN OF CLAYTON	(919) 868-3308	TCALLIHAN@TOWNOFCLAYTONNC.ORG
Kevin Smith	NCSII	336-707-4528	KSMITH@NCSII.ORG
Benjamin Powell	PNG	919-648-6189	benjamin.powell@duke-energy.com
Ricky McLamb	PNG	919-920-6489	RICKY.MCLAMB@duke-energy.com
Danny Denning	PNG	919-648-8308	danny.denning@duke-energy.com
David Akers	South River	919 820 0581	dakers@sremc.com
Linda Scharf Byers	PNG	919-705-5042	LINDA.SCHARF-BYERS@DUKE-ENERGY.COM