

Alamance – Chatham - Orange

February 2019



Blue Ridge Mountains, North Carolina

NC811 Board Meeting – Jan. 2019



Lyman Horne Receives
the Ray Killough Award



NC811 Open House – Jan. 2019



A photograph of a sunset over a mountain range. The sun is low on the horizon, casting a warm orange glow across the sky and the silhouettes of the mountains. The sky transitions from a deep orange near the horizon to a dark blue at the top. The foreground shows dark, silhouetted vegetation.

2018

what a great year!

A graphic featuring a man in a suit pointing at a blue hexagon with the text 'business analytics'. The background is dark blue with a hexagonal grid pattern and various business icons like a pie chart, bar chart, globe, and clock.

**business
analytics**

North Carolina 811
www.nc811.org



Locate Requests & Transmissions

Jan. 2019 vs 2018

Tickets

2019: 187,878

2018: 152,459

Difference: 23.2%

Transmissions

2019: 1,037,905

2018: 864,096

Difference: 23.3%

County Ticket Volume

YTD stats compared with previous year

Alamance	3 HR	CNCL	NEW	RXMT	UPDT	Total Tickets
2018	15	27	1,188	24	336	1,590
2019	44	26	2,093	49	792	3,004
+/- Var	193.3%	-3.7%	76.2%	104.2%	135.7%	88.9%
				Avg Locates per Day		158

County Ticket Distribution

ALAMANCE	3,004		
ALAMANCE	10	OSSIPEE	2
BURLINGTON	1424	PLEASANT GROVE	2
ELI WHITNEY	2	PLEASANT HILL	1
ELON	168	ROCK CREEK	1
GIBSONVILLE	36	SAXAPAHAW	12
GLEN RAVEN	13	SNOW CAMP	74
GLENCOE	2	SWEPSONVILLE	27
GRAHAM	703	UNION RIDGE	1
GREEN LEVEL	20	WOODLAWN	4
HAW RIVER	102		
KIMESVILLE	3		
MEBANE	397		

County Ticket Volume

YTD stats compared with previous year

Chatham	3 HR	CNCL	NEW	RXMT	UPDT	Total Tickets
2018	25	16	988	51	306	1,386
2019	57	13	1,164	43	499	1,776
+/- Var	128.0%	-18.8%	17.8%	-15.7%	63.1%	28.1%
				Avg Locates per Day		93

County Ticket Distribution



CHATHAM	1,776		
ASBURY	1	GULF	1
BEAR CREEK	40	MONCURE	24
BELLS	3	PITTSBORO	809
BENNETT	3	SEAFORTH	2
BONLEE	8	SILER CITY	240
BYNUM	1	SILK HOPE	1
CARY	286	TERRELLS	1
CORINTH	1	WILSONVILLE	8
FARRINGTON	113		
FEARRINGTON	192		
FEARRINGTON VILLAGE	6		
GOLDSTON	36		

County Ticket Volume

YTD stats compared with previous year

Orange	3 HR	CNCL	NEW	RXMT	UPDT	Total Tickets
2018	31	9	1,279	34	401	1,754
2019	62	33	1,539	40	762	2,436
+/- Var	100.0%	266.7%	20.3%	17.6%	90.0%	38.9%
				Avg Locates per Day		128

County Ticket Distribution



ORANGE	2,436
BLACKWOOD	2
CALDWELL	4
CARRBORO	223
CEDAR GROVE	40
CHAPEL HILL	1,384
CHEEKS CROSSROADS	5
DURHAM	63
EFLAND	60
ENO	4
HILLSBOROUGH	485
MEBANE	165
WHITE CROSS	1



REMOTE TICKET ENTRY



Damage Contact Info

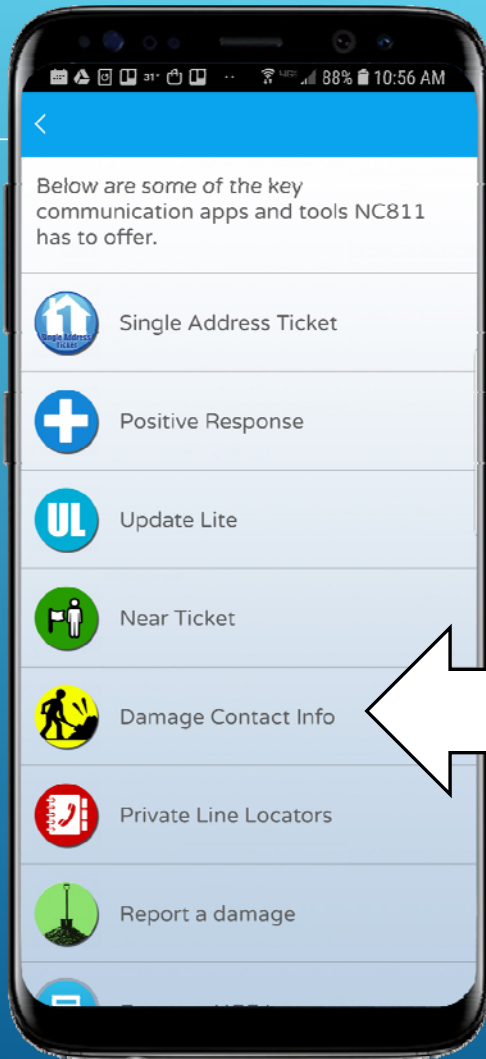

When a utility is damaged, know who to contact in your area with the Damage Contact section of the app.

County Member Damage Notification Information

NORTH CAROLINA

County

Members Notified for County ALAMANCE

Code	Name	Damage Contact	Phone
ATT01	ATT/T (TRANSMISSION)	ANTONIO J. PEIRANO	(803)261-4551
ATT312*	ATT/D (DISTRIBUTION)	ATT REPRESENTATIVE	(877)737-2478
ATT322*	ATT/D (DISTRIBUTION)	ATT REPRESENTATIVE	(877)737-2478
CAR01	CARDINAL PIPELINE COMPANY	GAS CONTROL	(800)440-8475
CAR02	CARDINAL PIPELINE COMPANY	GAS CONTROL	(800)440-8475
COB01	CITY OF BURLINGTON	ANDY MCCOY	(336)516-6525
COB02	CITY OF BURLINGTON	1 - DEAN COBLE	(336)516-6654
COB02	CITY OF BURLINGTON	2 - WALTER HARTMAN	(336)516-6655
COP02	COLONIAL PIPELINE COMPANY	CONTROL CTR SENIOR CONTROLLER	(800)926-2728
COP05	COLONIAL PIPELINE COMPANY	CONTROL CTR SENIOR CONTROLLER	(800)926-2728
CPL10*	DUKE ENERGY	DUKE ENERGY REPRESENTATIVE	(800)452-2777
CPL30*	DUKE ENERGY	DUKE ENERGY REPRESENTATIVE	(800)452-2777
CTT02*	CTLCL-CENTURYLINK	GENERAL NUMBER	(800)788-3600
CTT11*	CTLCL-CENTURYLINK	GENERAL NUMBER	(800)788-3600
CTT12*	CTLCL-CENTURYLINK	GENERAL NUMBER	(800)788-3600
CUB01	CONTERRA ULTRA BROADBAND	NETWORK OPERATIONS CENTER	(888)581-0811
CVI04*	TIME WARNER CABLE-CHARTER	CAROLINAS REGIONAL OPERATIONS	(855)272-2862
DET01*	TIME WARNER CABLE-CHARTER	CAROLINAS REGIONAL OPERATIONS	(855)272-2862
DOT07	NC DEPARTMENT OF TRANSPORTATION	MARK ALDRIDGE	(336)487-0175
DOT07A	NC DEPARTMENT OF TRANSPORTATION	OPERATIONS CENTER (EVENING)	(919)825-2653
DOT07A	NC DEPARTMENT OF TRANSPORTATION	TRIAD TMC (DAYTIME)	(336)315-7080
DPC11*	DUKE ENERGY	DUKE ENERGY REPRESENTATIVE	(800)769-3766
ELN01	TOWN OF ELON	1 - DAVID MURPHY	(336)214-0674
ELN01	TOWN OF ELON	2 - TJ TINGLE	(336)684-4296

**Your info should match
your white lined area**



**LOCATE
TICKET**





87-122 (c) (2) Confirm through positive response prior to excavation that all operators have responded & that all facilities that may be affected by the proposed excavation have been marked.

Member Response Codes

- 10 No conflict, utility is outside of stated work area
- 20 Marked
- 30 Not complete
- 32 Locate Not Complete, additional communication with the excavator required. Unable to contact the excavator.
- 40 Could not gain access to property, locator will contact excavator
- 50 Critical facility not marked, The utility owner or their designated representative have contacted the excavator and have agreed to a period that an owner representative must be present during excavation to identify the unmarked facility and/or monitor the excavation
- 55 Critical facility marked. The utility owner or their designated representative have contacted the excavator and have agreed that an owner representative must be present during excavation
- 60 Locator and excavator agreed and documented marking schedule
- 70 Excavator completed work prior to due date
- 80 Member's Master Contractor is responsible for locating facilities
- 90 SURVEY DESIGN REQUEST - Facility Has been Marked in the Field
- 92 SURVEY DESIGN REQUEST -No Facilities in the Area
- 94 SURVEY DESIGN REQUEST - Facility Records Provided
- 98 SURVEY DESIGN REQUEST - Access to Facility Records Provided
- 100 Location request denied due to Homeland Security Concern. Member utility operator needs to confirm legitimacy of the proposed excavation and may need additional information.
- 110 Subaqueous Facilities Present. Member utility owner will locate facilities within 10 full working days.
- 888 Extraordinary Circumstances Exist. Member utility owner unable to complete location request until (Date / Time).
- 999 Member has not responded by the required time

Destroyed Marks & 3 Hour Tickets

DESTROYED MARKS

If locate marks have been destroyed, the excavator must contact NC811 to issue a Destroyed Marks ticket requesting a remark of the area from the original ticket. A 3 Hour Ticket should not be used in case of destroyed marks.

3 HOUR TICKET

If an operator fails to respond to the positive response system, the excavator may proceed if there are no visible indications of a facility at the proposed excavation or demolition area, such as a pole, marker, pedestal, meter, or valve. However, if the excavator is aware of or observes indications of an unmarked facility at the proposed excavation or demolition area, the excavator shall not begin excavation or demolition until an additional call is made to the Notification Center detailing the facility and an arrangement is made for the facility to be marked by the operator within three hours from the time the additional call is received by the Notification Center.

Bad Weather Driving Tips

- Inspect their vehicles before departing. Check tires, lights, turn signals, wipers, windows, defroster, mirrors and loads. Report defects to the mechanic and have them repaired before you go on the road.
- Keep windows and lights clean and clear of dirt, snow, and ice.
- Use wipers, defrosters, and headlights to improve your visibility day or night. Headlights also help other drivers see you.
- Avoid distractions, such as cell phones or radios.
- Watch out for puddles and icy patches that could cause hydroplaning or skids.
- Do not attempt to drive through deep puddles. You could get stuck or wet the brakes.
- Avoid quick or sudden stops or turns.
- Increase your stopping distance.
- Wear your seat belt at all times and require passengers to do the same. There is no time for mistakes during bad weather. Bad weather affects all drivers. You must stay alert. Watch out for the other drivers, too. Drive defensively!





MEETINGS AND EVENTS

Meetings



- ▶ **NC811 Board Meeting 1Q19**
April 26th, 2019
8:30 am; DoubleTree by
Asheville Hilton – Biltmore, NC
- ▶ **NC Underground Damage
Prevention Review Board**
April 16, 2019 from 10 am to 4 pm
2550 Operation Way, Raleigh, NC
- **Locate Resolution Partnership
Committee**
The 3rd Wednesday,
Feb, April, June, August, Oct, Dec
11:00 am - 1:00 pm
5009 High Point Rd., Greensboro, NC
- **State UCC**
March 12, 2019 from 10 am to noon
Dominion Energy, 4211 Global St,
Raleigh, NC

Joint NC/SC Utilities



**Sheraton Myrtle Beach Convention Center
May 1st - May 3rd, 2019**

For more info and to register go to: www.scucc.org



Thank you for your time and attention.
You can get a PDF copy of this presentation
on www.ncucc.org



Use the UCC Issues form to voice your concerns
to both local and state level UCC meetings in North Carolina.
Available on both the NCUCC website and the NC811 app.

UCC SIGN IN

COUNTY: ALAMANCE, CHATHAM, ORANGE DATE: 2 / 6 / 2019

NAME	COMPANY	CELL NUMBER	EMAIL ADDRESS
Kevin Smith	NC811	336-707-4528	KSMITH@NC811.ORG
Todd Perry	PSNC	919-819-9831	TPerry@SCANAL.com
Jonathan Dean	PSNC	919-257-8129	Jdean@scanal.com
AARON DUNCAN	ITS	1-919-671-5403	aduncan@its-nc.com
TUCKER BULLOCK	PSNC	919-819-0593	TBULLOCK@SCANAL.com
Drew Baranosky	TRC Construction	919-257-0121	Drew@TRCConstruction.us
SETH RUNKETT	ETI	336-509-5815	RUNKETTS@ETITEAM.COM
JEFF HILL	ETI	336-516-4933	Hillj@eti-team.com
DAVID McCollum	Poles Plumbing	919-353-1122	davidm@polesplumbing.com
LEE PARRIS	NC DOT	910-417-9411	SLPARRIS2@NC DOT.GOV
TONY ARMEN	DNIE PIPELINE	919-290-2210	armen@EPROD.COM
Howard Jordan	PNG / DUKE-ENERGY	336-516-0339	howard.jordan@duke-energy.com
Brandon Boswell	City of Mebane/public works	336-263-4119	bboswell@cityofmebane.com
Chris Crutchfield	City of Mebane	336-214-2103	CCrutchfield@Cityofmebane.com
Wayne Pore	city of mebane	336-516-8396	WPore@cityofmebane.com
Joshua McNeill	PSN.C	919-819-9984	PotHolesUSA@BellSouth.NET
Bill MANESS	PotHoles USA	336-376-3900	
Robert MANESS	"	"	
Chris Watson	USIC	336-953-4785	christopher.watson@usicllc.com

UCC SIGN IN

COUNTY: Harmon / Chatham / Orange DATE: 2 / 6 / 19

[illegible]